

United States Patent [19]

Zuckerman

[11] Patent Number: 5,069,000

[45] Date of Patent: Dec. 3, 1991

[54] REVERSING APPARATUS FOR POWERED VEHICLE DOOR SYSTEMS

[75] Inventor: Lawrence H. Zuckerman, Easton, Pa.

[73] Assignee: Masco Industries, Inc., Taylor, Mich.

[21] Appl. No.: 497,546

[22] Filed: Mar. 22, 1990

[51] Int. Cl.⁵ E05F 15/02

[52] U.S. Cl. 49/28; 49/214; 49/360

[58] Field of Search 49/214, 213, 362, 360, 49/28, 29, 30

[56] **References Cited**

U.S. PATENT DOCUMENTS

2,628,091	2/1953	Rappl .	
3,069,151	12/1962	Cook et al. .	
3,124,344	3/1964	Mano .	
3,141,662	7/1964	Wise .	
3,202,414	8/1965	Simmons et al. .	
3,344,554	10/1967	Misaka et al. .	
3,398,484	8/1968	Katsumura et al. .	
3,479,767	11/1969	Gardner et al. .	
3,653,154	4/1972	Hayday .	
3,844,062	10/1974	Daugirdal	49/214 X
3,893,260	7/1975	Cadiou .	
4,121,382	10/1978	Dietrich et al. .	
4,183,177	1/1980	Kurdziel .	
4,314,692	2/1982	Brauer et al. .	
4,422,521	12/1983	Mochida .	
4,462,185	7/1984	Shibuki et al. .	
4,489,640	12/1984	Olson .	
4,530,185	7/1985	Moriya et al. .	
4,546,845	10/1985	Meyer et al. .	
4,549,369	10/1985	Foley, Jr. .	
4,612,729	9/1986	Sato .	
4,617,757	10/1986	Kagiyama et al. .	
4,621,223	11/1986	Murakami et al.	49/28 X

4,640,050	2/1987	Yamagishi et al. .	
4,644,692	2/1987	Schindehutte .	
4,644,693	2/1987	Wang .	
4,686,598	8/1987	Herr	49/28 X
4,775,178	10/1988	Boyko .	
4,831,509	5/1989	Jones et al.	49/28 X
4,842,313	6/1989	Boyko et al. .	
4,862,640	9/1989	Boyko et al. .	
4,887,390	12/1989	Boyko et al. .	

FOREIGN PATENT DOCUMENTS

0017515	10/1980	European Pat. Off. .	
3523261	1/1986	Fed. Rep. of Germany .	
2578078	8/1986	France .	
620336	3/1949	United Kingdom .	

Primary Examiner—Philip C. Kannan
Attorney, Agent, or Firm—Harness, Dickey & Pierce

[57] **ABSTRACT**

An obstruction detecting reversing apparatus is disclosed for a motor driven device, such as a powered vehicle door or window system, wherein the device undergoes varying loads, and consequently varying current draws, during normal operation. In order to accurately detect the presence of an obstruction, in light of such normally varying currents, the apparatus circuit logic monitors instantaneous motor current and compares it with the time average of motor current over a very short preceding time interval, which "tracks" normal current draw in order to sense an obstruction-caused rise in motor current at virtually any stage of the door closing operation, and thus also accommodates normal changes in current draw caused by different gravity effects when the device is oriented in different grade-caused orientations.

18 Claims, 16 Drawing Sheets

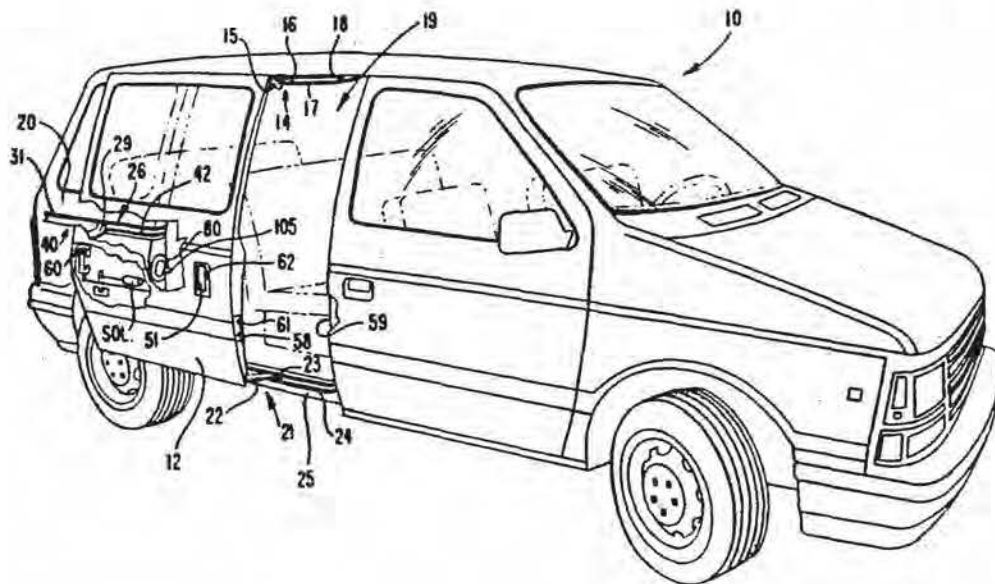

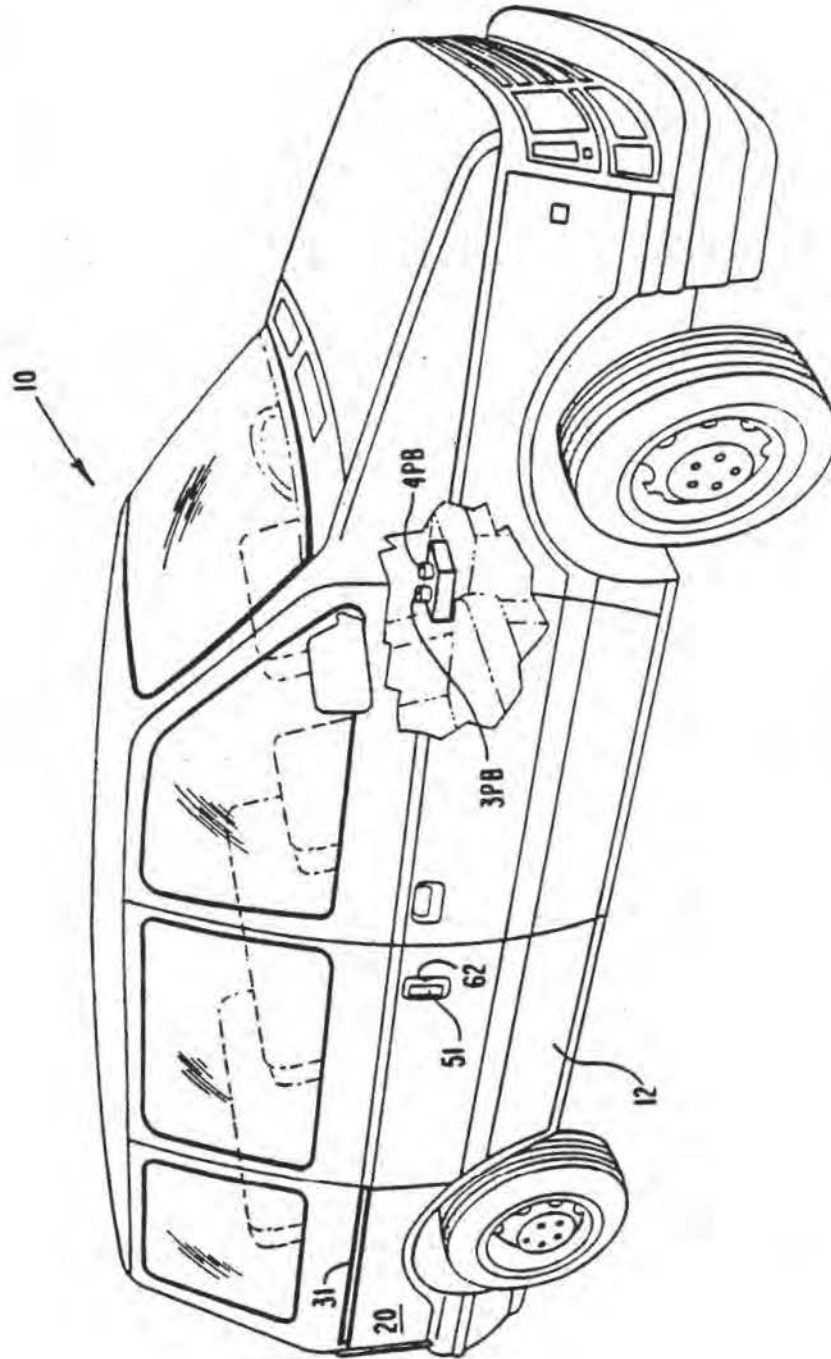
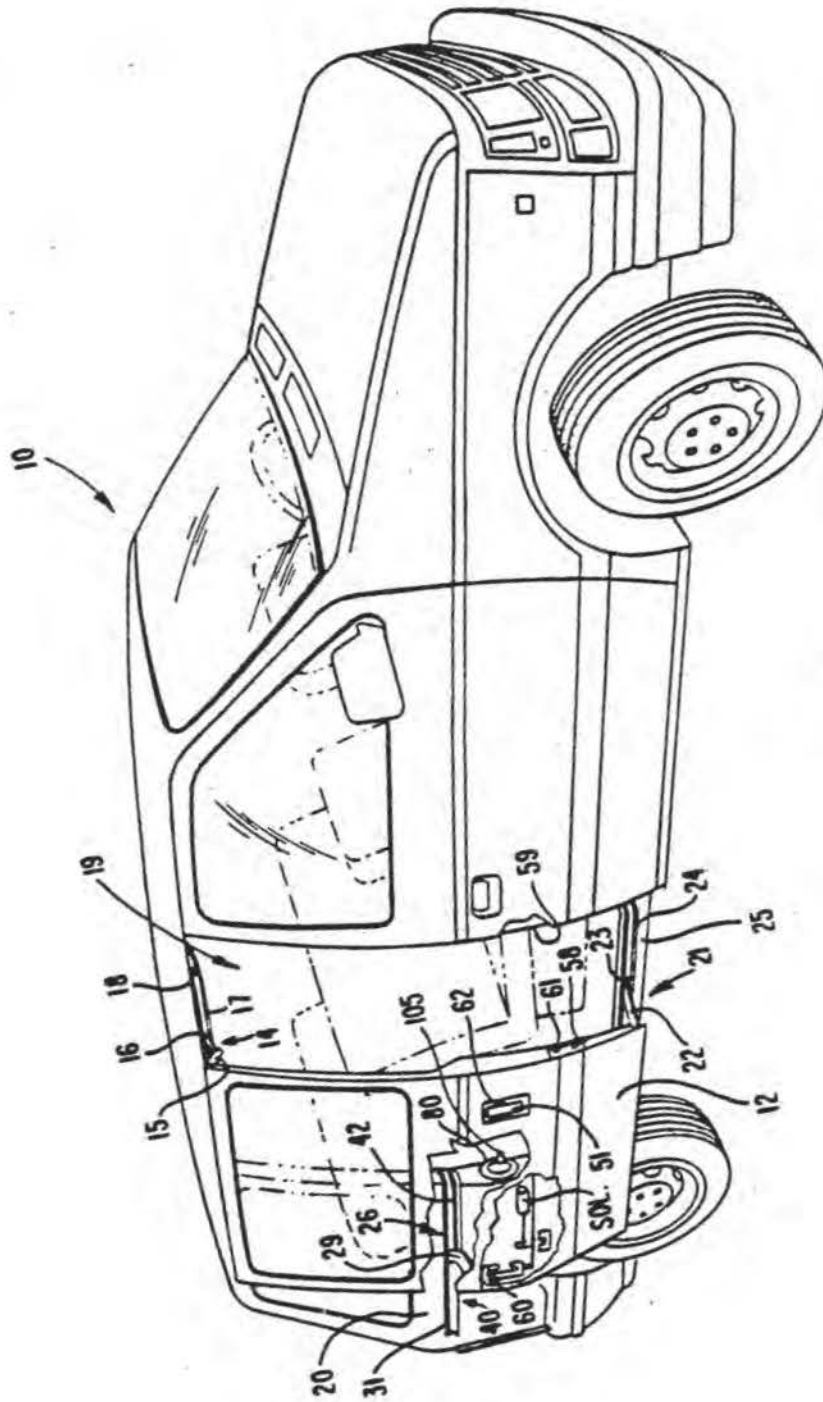

FIG. 1



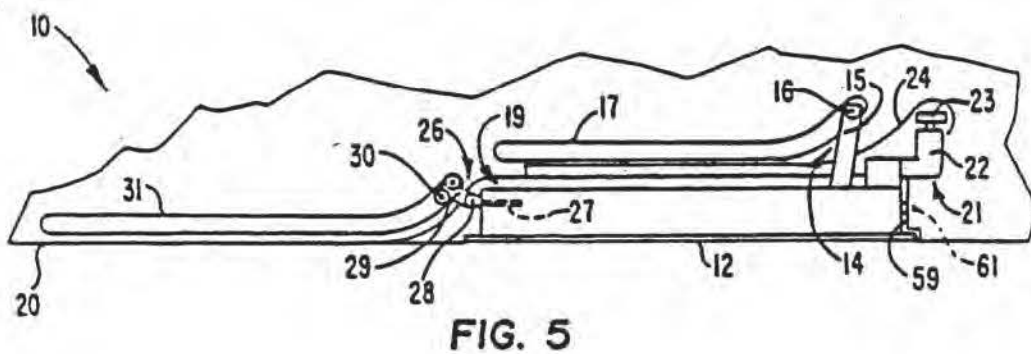
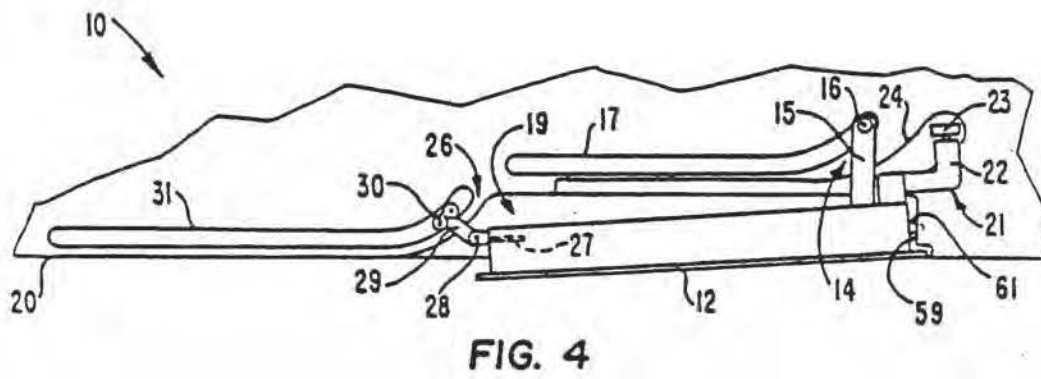
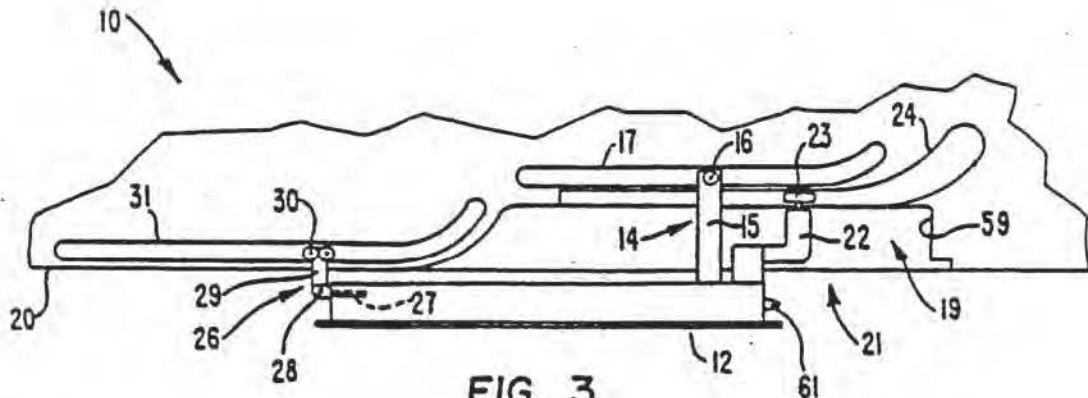
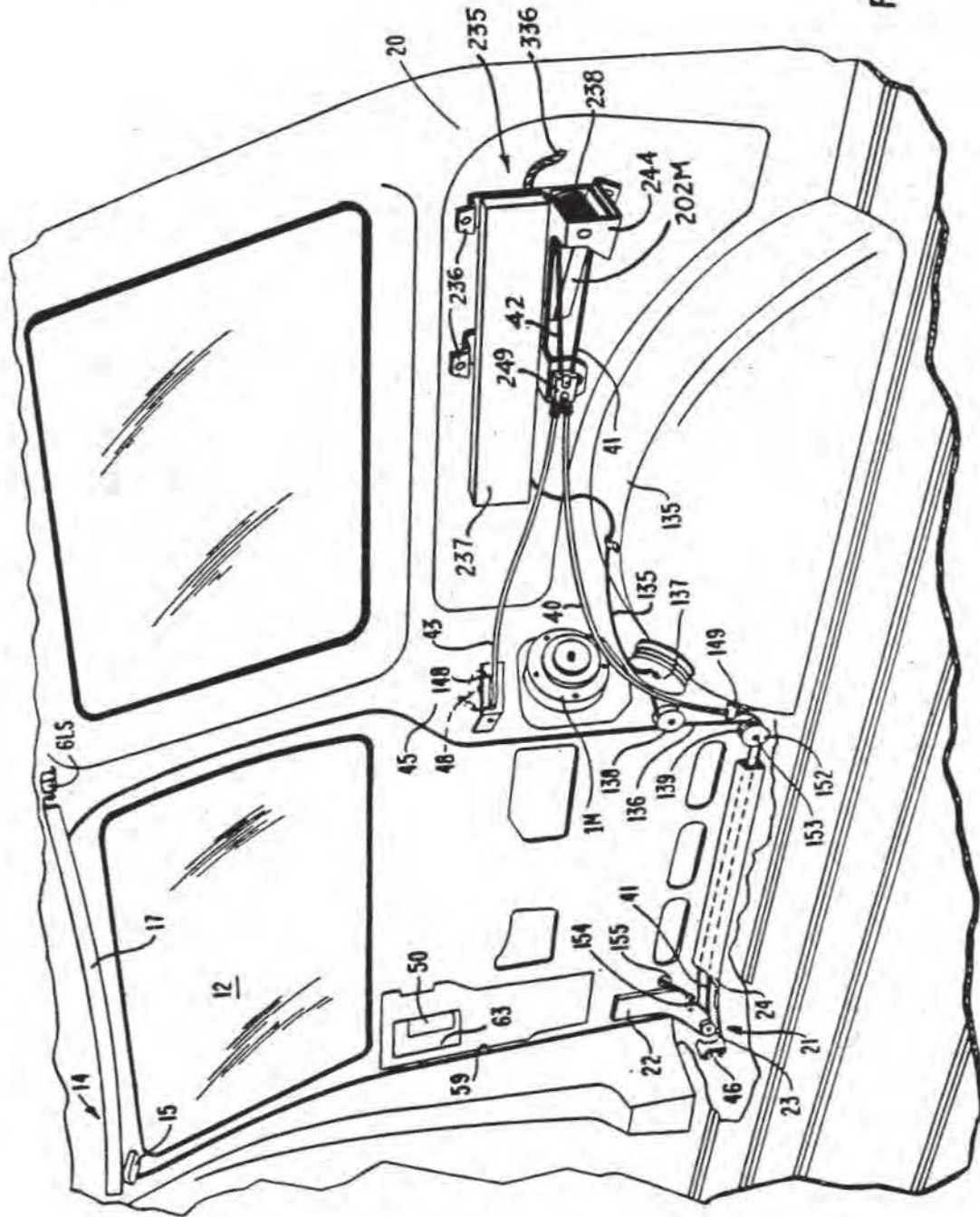

FIG. 6



Explore Litigation Insights

Docket Alarm provides insights to develop a more informed litigation strategy and the peace of mind of knowing you're on top of things.

Real-Time Litigation Alerts



Keep your litigation team up-to-date with **real-time alerts** and advanced team management tools built for the enterprise, all while greatly reducing PACER spend.

Our comprehensive service means we can handle Federal, State, and Administrative courts across the country.

Advanced Docket Research



With over 230 million records, Docket Alarm's cloud-native docket research platform finds what other services can't. Coverage includes Federal, State, plus PTAB, TTAB, ITC and NLRB decisions, all in one place.

Identify arguments that have been successful in the past with full text, pinpoint searching. Link to case law cited within any court document via Fastcase.

Analytics At Your Fingertips



Learn what happened the last time a particular judge, opposing counsel or company faced cases similar to yours.

Advanced out-of-the-box PTAB and TTAB analytics are always at your fingertips.

API

Docket Alarm offers a powerful API (application programming interface) to developers that want to integrate case filings into their apps.

LAW FIRMS

Build custom dashboards for your attorneys and clients with live data direct from the court.

Automate many repetitive legal tasks like conflict checks, document management, and marketing.

FINANCIAL INSTITUTIONS

Litigation and bankruptcy checks for companies and debtors.

E-DISCOVERY AND LEGAL VENDORS

Sync your system to PACER to automate legal marketing.