

# United States Patent [19]

Androphy

[11] Patent Number: 4,567,885

[45] Date of Patent: Feb. 4, 1986

[54] **TRIPLANAR KNEE RESECTION SYSTEM**

[76] Inventor: Gary W. Androphy, P.O. Box 533, Gurnee, Ill. 60031

[21] Appl. No.: 651,681

[22] Filed: Sep. 18, 1984

### Related U.S. Application Data

[62] Division of Ser. No. 317,875, Nov. 3, 1981, Pat. No. 4,487,203.

[51] Int. Cl.<sup>4</sup> ..... A61F 5/04

[52] U.S. Cl. .... 128/92 H; 128/303 R

[58] Field of Search ..... 128/92 H, 92 R, 303 R

### References Cited

#### U.S. PATENT DOCUMENTS

4,211,228 7/1980 Cloutier ..... 128/303 R  
4,487,203 12/1984 Androphy ..... 128/303 R

#### OTHER PUBLICATIONS

"Knee Replacement Using the Insall/Burstein Total Condylar Knee System", Zimmer Inc., Warsaw, IN, 1980.

"R.M.C. Total Knee System", Richards Mfg. Co. Inc., Memphis, TN, 1978.

"Total Condylar Knee Prosthesis Surg. Tech.", Howmedica Inc., Rutherford, N.J., 1978.

"The Howmedica Universal Total Knee Instrument System", Howmedica Inc., 1980.

Primary Examiner—Gene Mancene

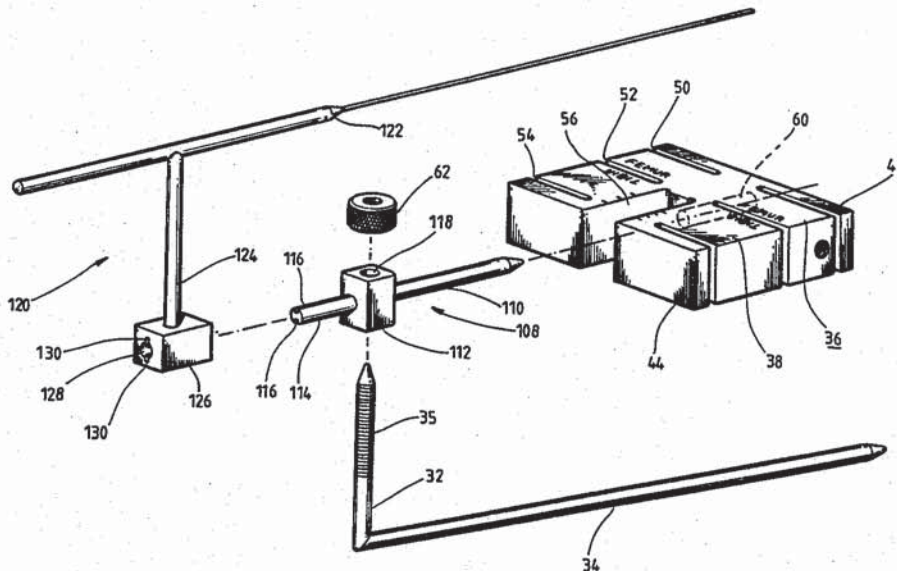
Assistant Examiner—C. W. Shedd

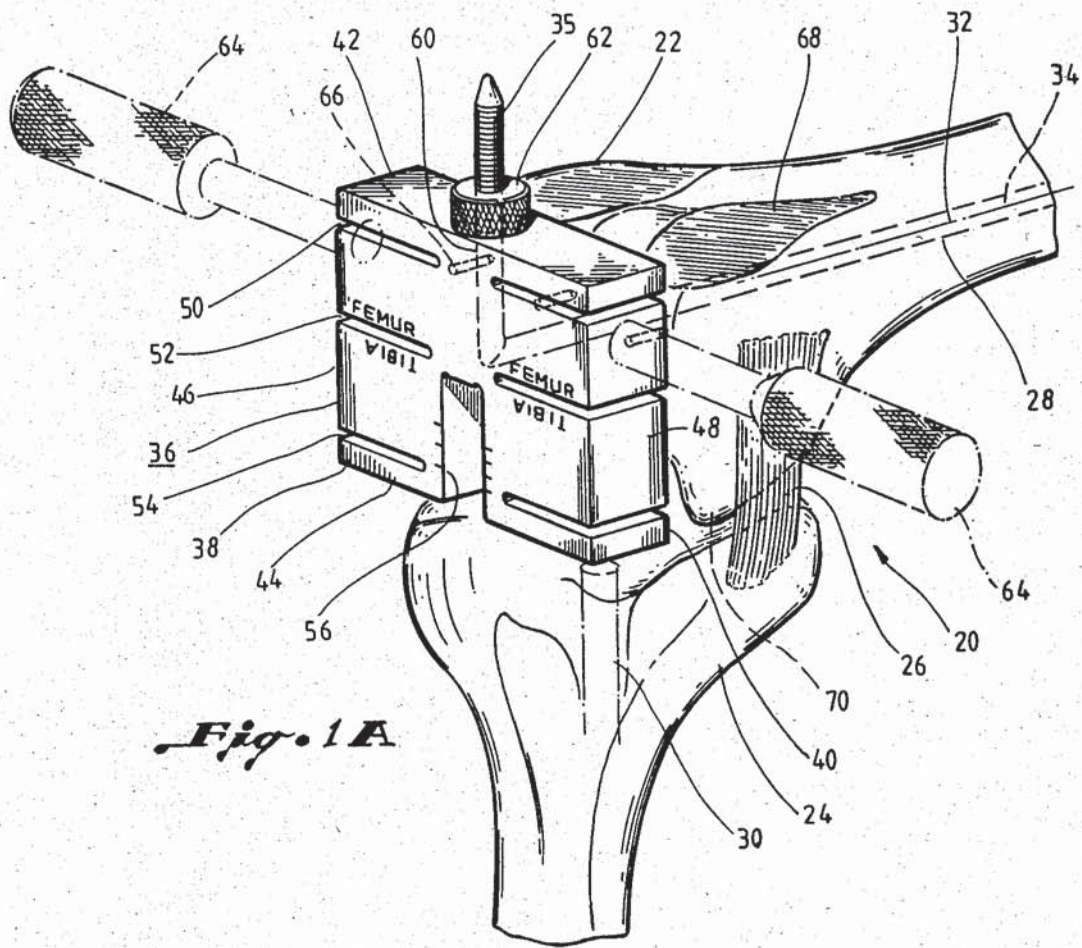
Attorney, Agent, or Firm—Arnold, White & Durkee

### [57] ABSTRACT

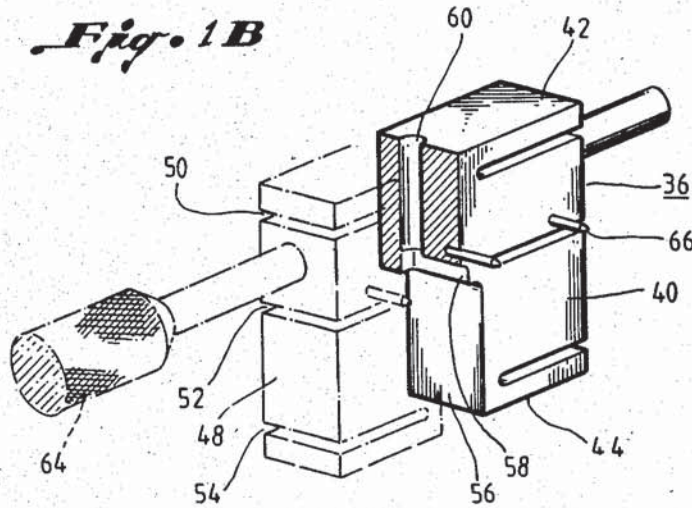
An improved triplanar knee resection system is provided for preparing a knee joint for a prosthesis. The apparatus of the triplanar knee system includes a single guide member for use in resecting the distal femoral condyles, the proximal tibia, and the distal femur. The guide member cooperates with a simplified set of instruments, including femur and tibia guide rods, a tibia adaptor, a tibia bar, and a femur bar, for establishing equal flexion and extension gaps and triplanar resections. The method of the triplanar knee system provides a simplified procedure for use by an orthopedic surgeon in properly preparing a knee joint for implantation of a prosthesis.

5 Claims, 16 Drawing Figures

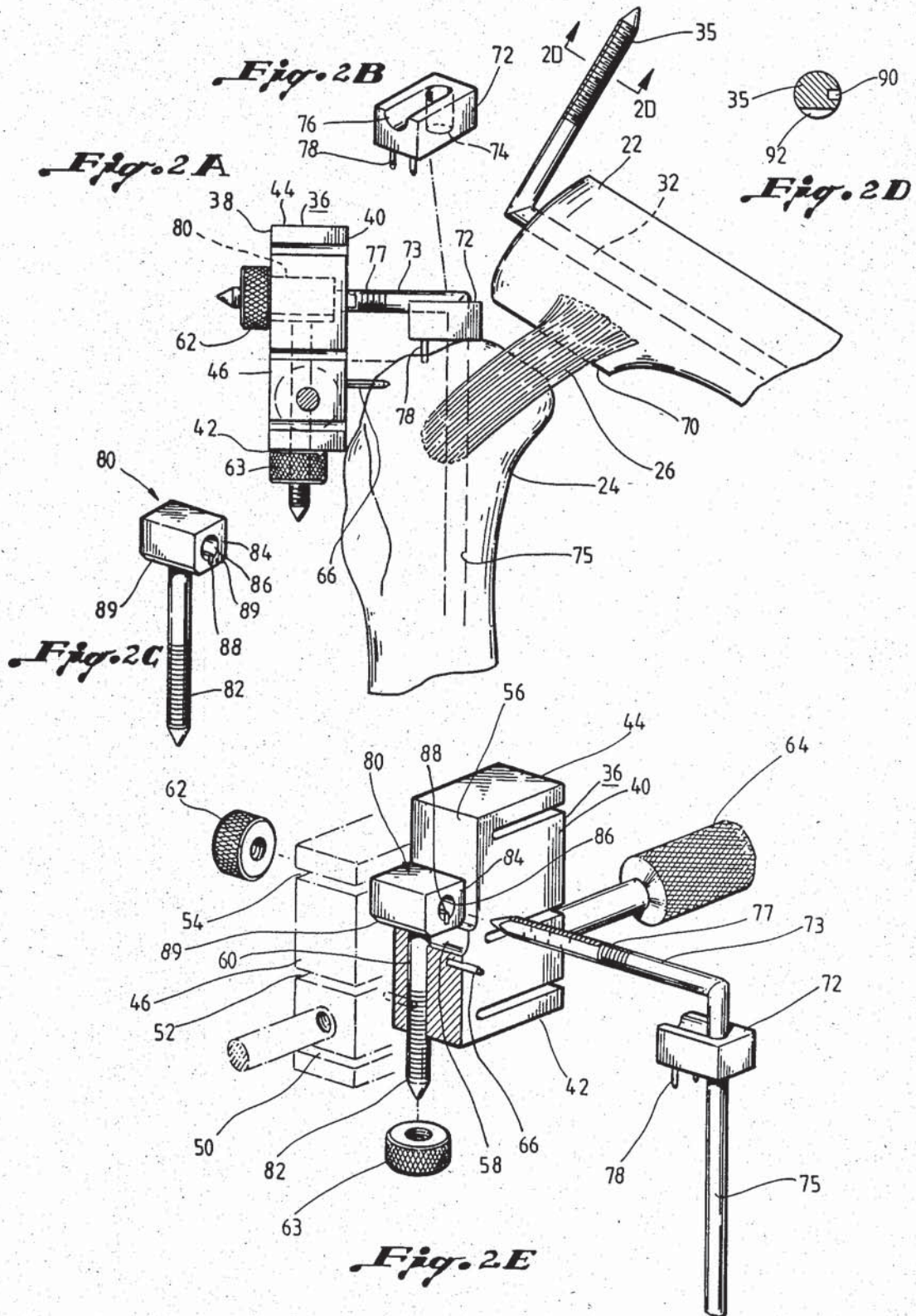


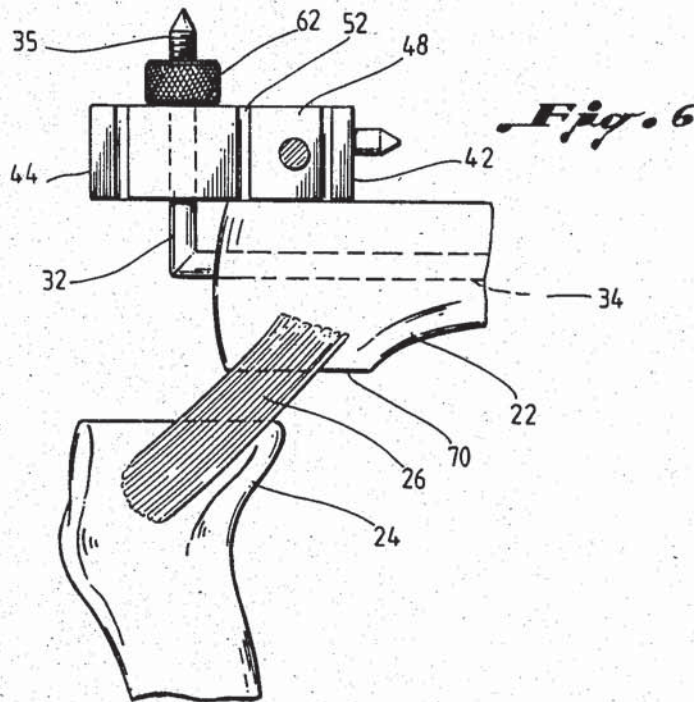
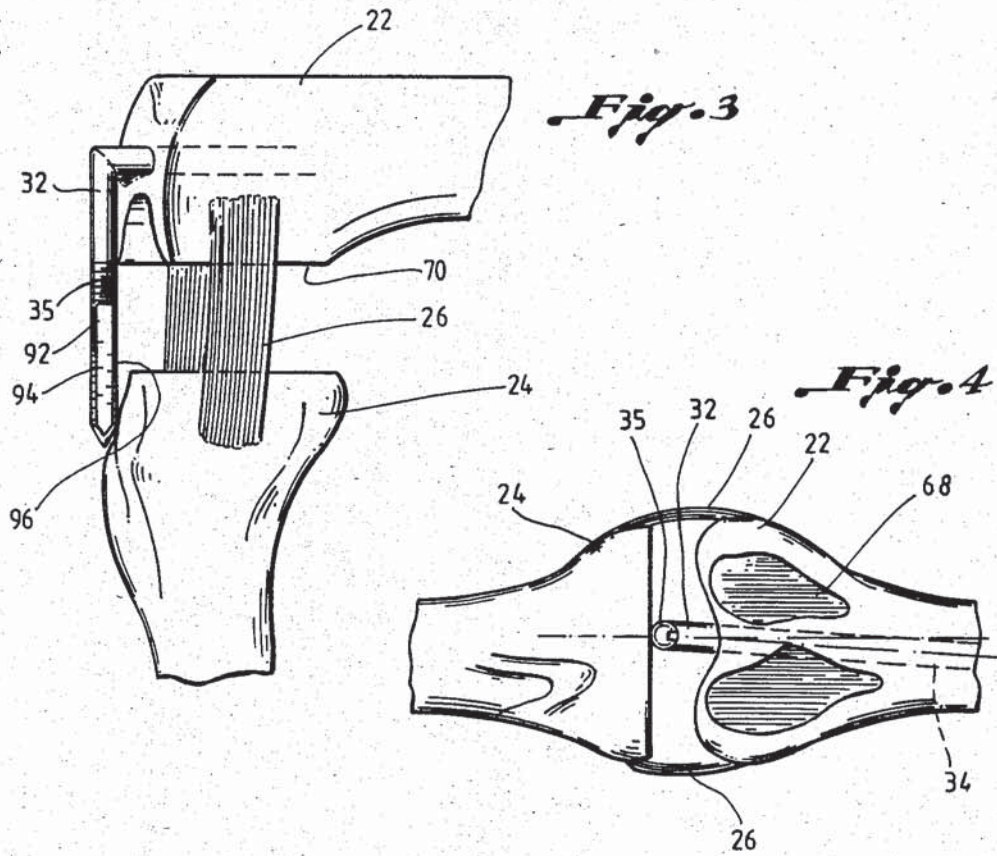


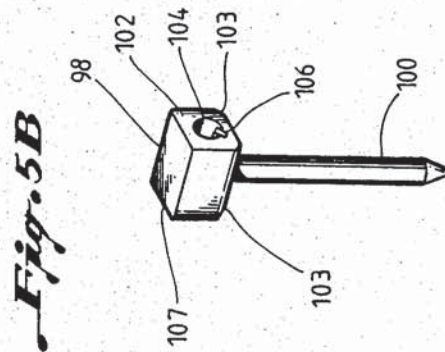
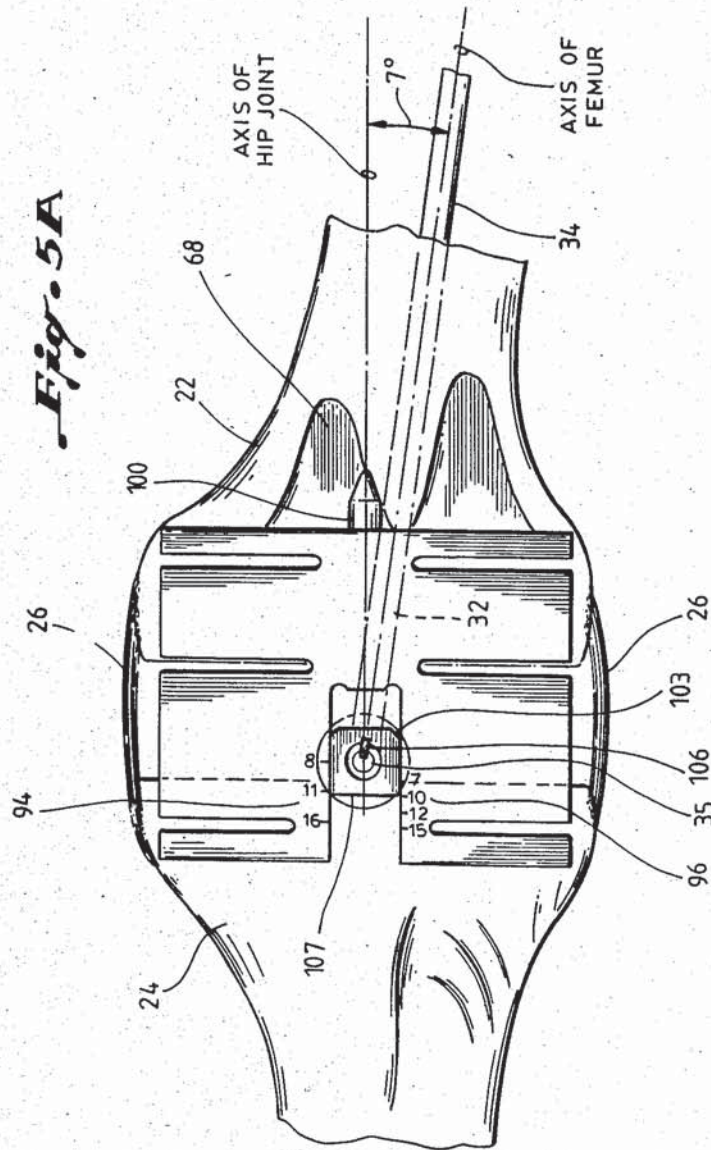
*Fig. 1A*



*Fig. 1B*







# Explore Litigation Insights

Docket Alarm provides insights to develop a more informed litigation strategy and the peace of mind of knowing you're on top of things.

## Real-Time Litigation Alerts



Keep your litigation team up-to-date with **real-time alerts** and advanced team management tools built for the enterprise, all while greatly reducing PACER spend.

Our comprehensive service means we can handle Federal, State, and Administrative courts across the country.

## Advanced Docket Research



With over 230 million records, Docket Alarm's cloud-native docket research platform finds what other services can't. Coverage includes Federal, State, plus PTAB, TTAB, ITC and NLRB decisions, all in one place.

Identify arguments that have been successful in the past with full text, pinpoint searching. Link to case law cited within any court document via Fastcase.

## Analytics At Your Fingertips



Learn what happened the last time a particular judge, opposing counsel or company faced cases similar to yours.

Advanced out-of-the-box PTAB and TTAB analytics are always at your fingertips.

## API

Docket Alarm offers a powerful API (application programming interface) to developers that want to integrate case filings into their apps.

## LAW FIRMS

Build custom dashboards for your attorneys and clients with live data direct from the court.

Automate many repetitive legal tasks like conflict checks, document management, and marketing.

## FINANCIAL INSTITUTIONS

Litigation and bankruptcy checks for companies and debtors.

## E-DISCOVERY AND LEGAL VENDORS

Sync your system to PACER to automate legal marketing.