



US006904798B2

(12) **United States Patent**
Boucher et al.

(10) **Patent No.:** **US 6,904,798 B2**
(45) **Date of Patent:** **Jun. 14, 2005**

(54) **MULTI-FUNCTIONAL MARINE SENSING INSTRUMENT**

5,719,824 A 2/1998 Boucher
5,838,635 A 11/1998 Masreliez

(75) Inventors: **Stephen G. Boucher**, Amherst, NH (US); **Robert M. Cullen**, Temple, NH (US); **Jun Lan**, Milford, NH (US)

FOREIGN PATENT DOCUMENTS
DE 44 12 964 A1 10/1994
DE 100 09 644 A1 9/2001
EP 0 973 150 A2 1/2000

(73) Assignee: **Airmar Technology Corporation**, Milford, NH (US)

OTHER PUBLICATIONS

(*) Notice: Subject to any disclaimer, the term of this patent is extended or adjusted under 35 U.S.C. 154(b) by 0 days.

Transom Mount. Airmar Technology Corporation. [online], 2000 #17-1205, [retrieved on Mar. 31, 2004]. Retrieved from the Internet, <URL:http://www.airmar.com/pdfs/cat/marine/transom_mount/transom.pdf>.

* cited by examiner

(21) Appl. No.: **10/630,625**

(22) Filed: **Jul. 30, 2003**

(65) **Prior Publication Data**

US 2004/0074294 A1 Apr. 22, 2004

Related U.S. Application Data

(60) Provisional application No. 60/429,514, filed on Nov. 26, 2002, and provisional application No. 60/402,493, filed on Aug. 8, 2002.

(51) **Int. Cl.**⁷ **G01P 13/00**

(52) **U.S. Cl.** **73/170.02**

(58) **Field of Search** 73/170.02, 170.03, 73/170.11, 170.13, 181, 185, 187, 861.78, 861.79, 861.81

(56) **References Cited**

U.S. PATENT DOCUMENTS

4,455,503 A 6/1984 Nakatani
4,836,020 A 6/1989 Boucher
5,182,952 A 2/1993 Pyzik
5,235,557 A 8/1993 Masreliez
5,581,025 A * 12/1996 Boucher et al. 73/187

Primary Examiner—William Oen

(74) *Attorney, Agent, or Firm*—Hamilton, Brook, Smith & Reynolds, P.C.

(57) **ABSTRACT**

A marine sensor device mounts in a single opening in a hull of a marine vessel. The sensor includes a housing secured in the opening. Positioned within the housing is a body containing at least two sensors. The body is removable from the housing. A magnetized paddlewheel can be disposed in a first cavity formed on a first half of the body, the paddlewheel has a plurality of paddles extending from a circular central hub and rotatably mounted on an axle extending transverse a fore and aft direction of travel of the vessel. A magnetic sensor can be located adjacent the paddles, the magnetic sensor senses the rotation of the paddles and provides speed indications. The magnetic sensor can be a Hall-effect device. A sonic transducer for depth detection can be disposed within a second cavity formed on a second half of the body. A thermal sensor for sensing water temperature can be disposed in a well formed in the body.

18 Claims, 11 Drawing Sheets

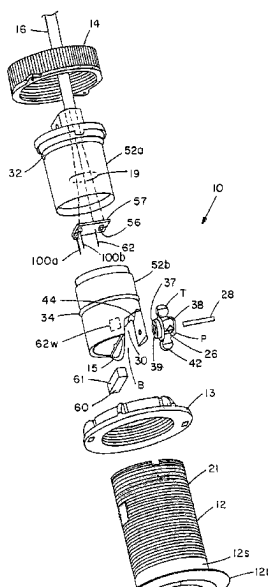

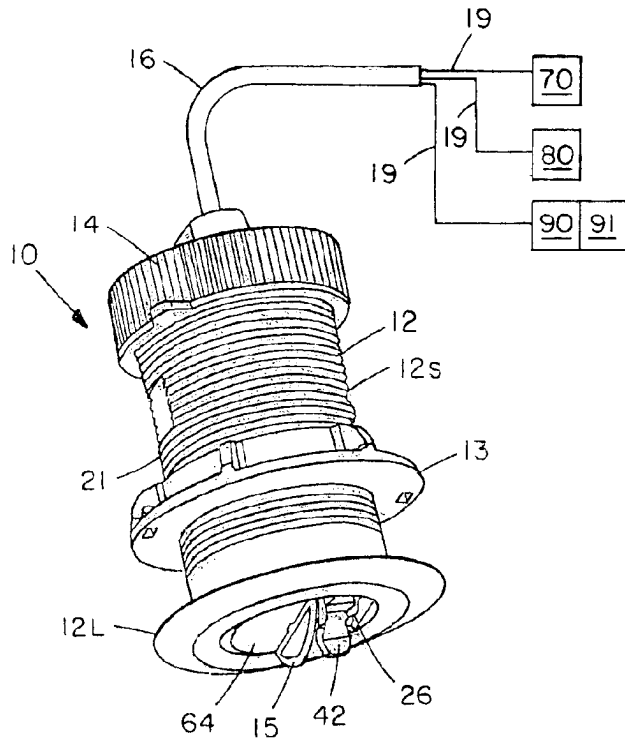

FIG. 1

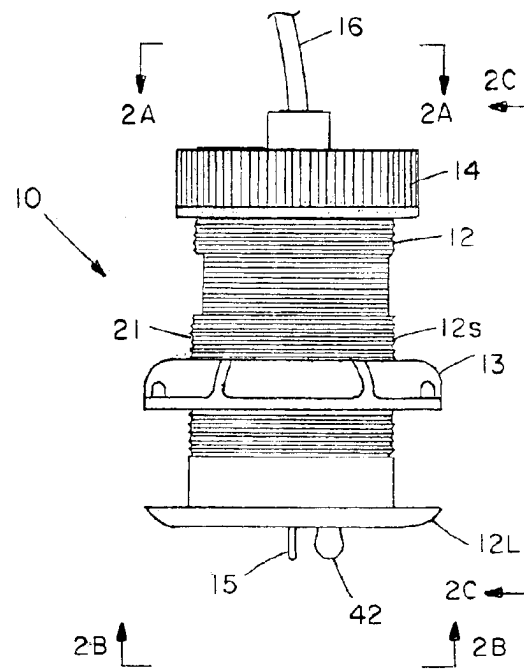

FIG. 2

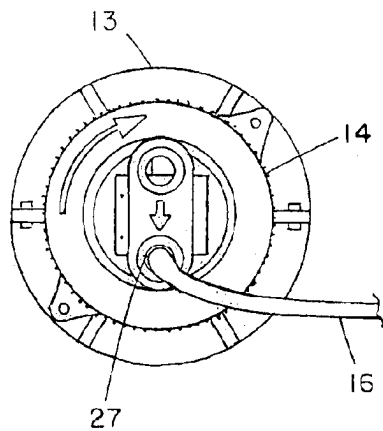

FIG. 2A

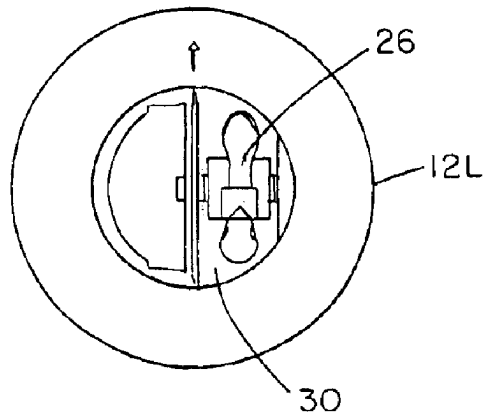

FIG. 2B

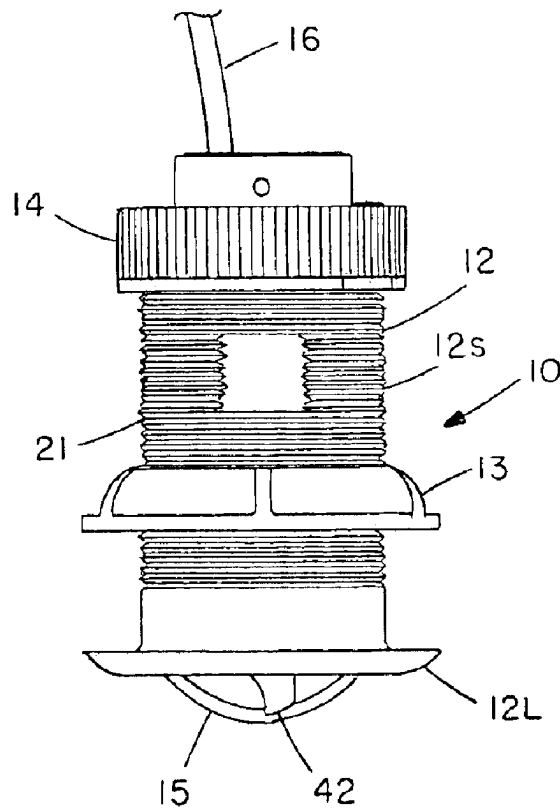

FIG. 2C

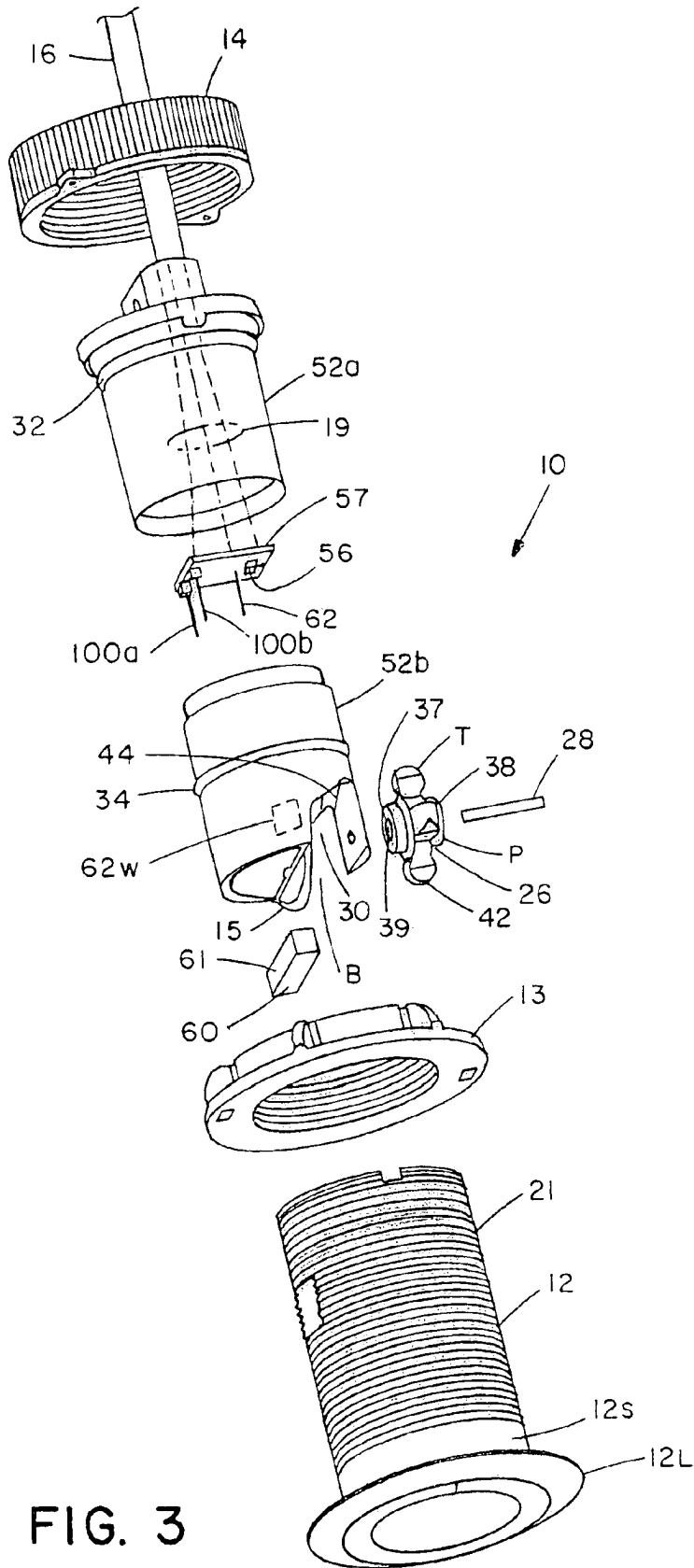

FIG. 3

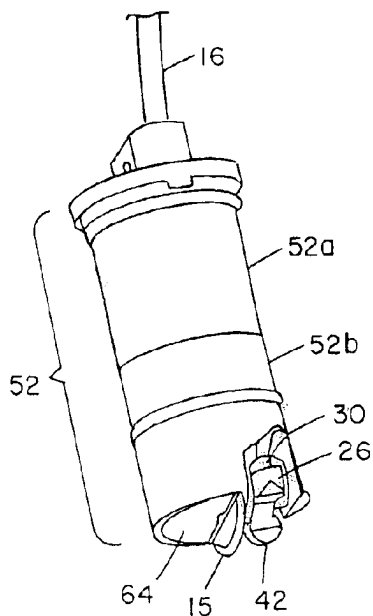

FIG. 4

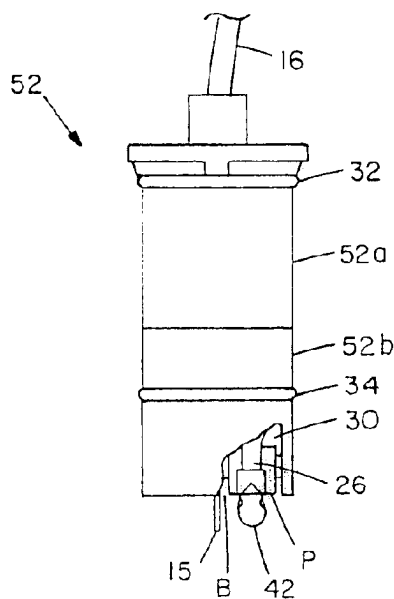

FIG. 5

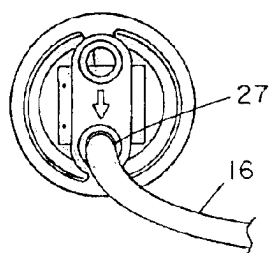

FIG. 5A

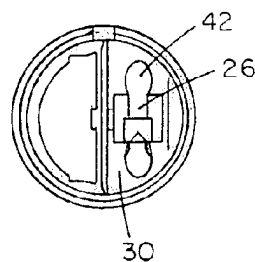

FIG. 5B

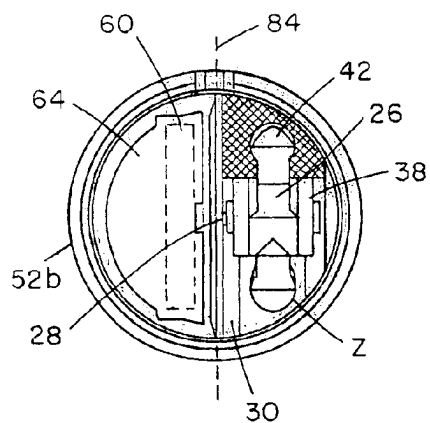

FIG. 5Ba

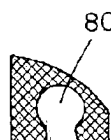

FIG. 5Bb

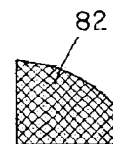

FIG. 5Bc

Explore Litigation Insights

Docket Alarm provides insights to develop a more informed litigation strategy and the peace of mind of knowing you're on top of things.

Real-Time Litigation Alerts



Keep your litigation team up-to-date with **real-time alerts** and advanced team management tools built for the enterprise, all while greatly reducing PACER spend.

Our comprehensive service means we can handle Federal, State, and Administrative courts across the country.

Advanced Docket Research



With over 230 million records, Docket Alarm's cloud-native docket research platform finds what other services can't. Coverage includes Federal, State, plus PTAB, TTAB, ITC and NLRB decisions, all in one place.

Identify arguments that have been successful in the past with full text, pinpoint searching. Link to case law cited within any court document via Fastcase.

Analytics At Your Fingertips



Learn what happened the last time a particular judge, opposing counsel or company faced cases similar to yours.

Advanced out-of-the-box PTAB and TTAB analytics are always at your fingertips.

API

Docket Alarm offers a powerful API (application programming interface) to developers that want to integrate case filings into their apps.

LAW FIRMS

Build custom dashboards for your attorneys and clients with live data direct from the court.

Automate many repetitive legal tasks like conflict checks, document management, and marketing.

FINANCIAL INSTITUTIONS

Litigation and bankruptcy checks for companies and debtors.

E-DISCOVERY AND LEGAL VENDORS

Sync your system to PACER to automate legal marketing.