

# EXHIBIT 5

U 7608123

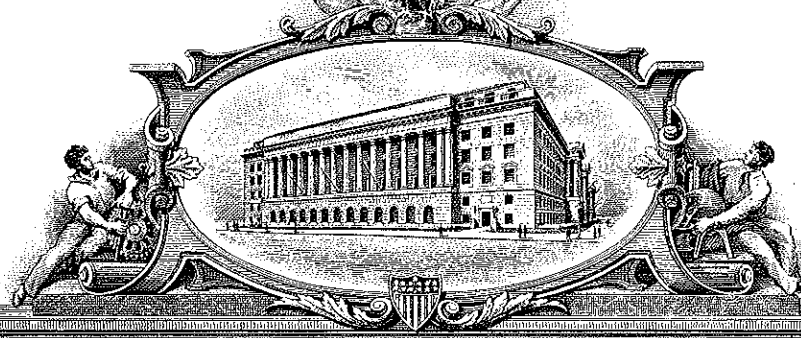

# THE UNITED STATES OF AMERICA

**TO ALL TO WHOM THESE PRESENTS SHALL COME:**

UNITED STATES DEPARTMENT OF COMMERCE  
United States Patent and Trademark Office

October 27, 2016

THIS IS TO CERTIFY THAT ANNEXED HERETO IS A TRUE COPY FROM  
THE RECORDS OF THIS OFFICE OF:

U.S. PATENT: 7,928,348  
ISSUE DATE: *April 19, 2011*

By Authority of the  
Under Secretary of Commerce for Intellectual Property  
and Director of the United States Patent and Trademark Office



R GLOVER  
Certifying Officer



US007928348B2

(12) **United States Patent**  
**Neal**

(10) **Patent No.:** **US 7,928,348 B2**  
(45) **Date of Patent:** **Apr. 19, 2011**

(54) **ELECTROMAGNETIC DEVICE WITH INTEGRATED FLUID FLOW PATH**

6,783,413 B2 \* 8/2004 Nakata et al. .... 440/89 R  
2006/0055264 A1 \* 3/2006 Johnson et al. .... 310/156.23  
2007/0075463 A1 \* 4/2007 Huang et al. .... 264/489

(75) Inventor: **Griffith D. Neal**, Alameda, CA (US)

**FOREIGN PATENT DOCUMENTS**

(73) Assignee: **Encap Technologies Inc.**, Alameda, CA (US)

JP 63118559 A \* 5/1988

\* cited by examiner

(\* ) Notice: Subject to any disclaimer, the term of this patent is extended or adjusted under 35 U.S.C. 154(b) by 1171 days.

*Primary Examiner* — Quang T Van

(74) *Attorney, Agent, or Firm* — Brinks Hofer Gilson & Lione; Steven P. Shurtz

(21) Appl. No.: **11/489,911**

(22) Filed: **Jul. 19, 2006**

(57) **ABSTRACT**

(65) **Prior Publication Data**

US 2008/0029506 A1 Feb. 7, 2008

Electromagnetic components are provided with a heat exchange mechanism. For example, a fluid-cooled electromagnetic field-functioning device, such as a motor, generator, transformer, solenoid or relay, includes one or more electrical conductors. A monolithic body of phase change material substantially encapsulates the conductors or an inductor. At least one liquid-tight coolant channel is also substantially encapsulated within the body of phase change material. The coolant channel may be part of a heat pipe or cold plate. The coolant channel may be made by molding a conduit into the body, using a "lost wax" molding process, or injecting gas into the molten phase change material while it is in the mold. The coolant channel may also be formed at the juncture between the body and a cover over the body.

(51) **Int. Cl.**  
**H05B 6/10** (2006.01)  
**H02K 9/20** (2006.01)

(52) **U.S. Cl.** ..... 219/628; 310/54; 310/43

(58) **Field of Classification Search** ..... 219/628; 310/43, 54, 55, 67 R, 89, 90, 156.23; 165/104.14, 165/212, 214, 272.4, 285, 311; 62/101  
See application file for complete search history.

(56) **References Cited**

**U.S. PATENT DOCUMENTS**

4,678,881 A \* 7/1987 Griffith ..... 219/631  
5,534,097 A \* 7/1996 Fasano et al. .... 156/214

**27 Claims, 14 Drawing Sheets**

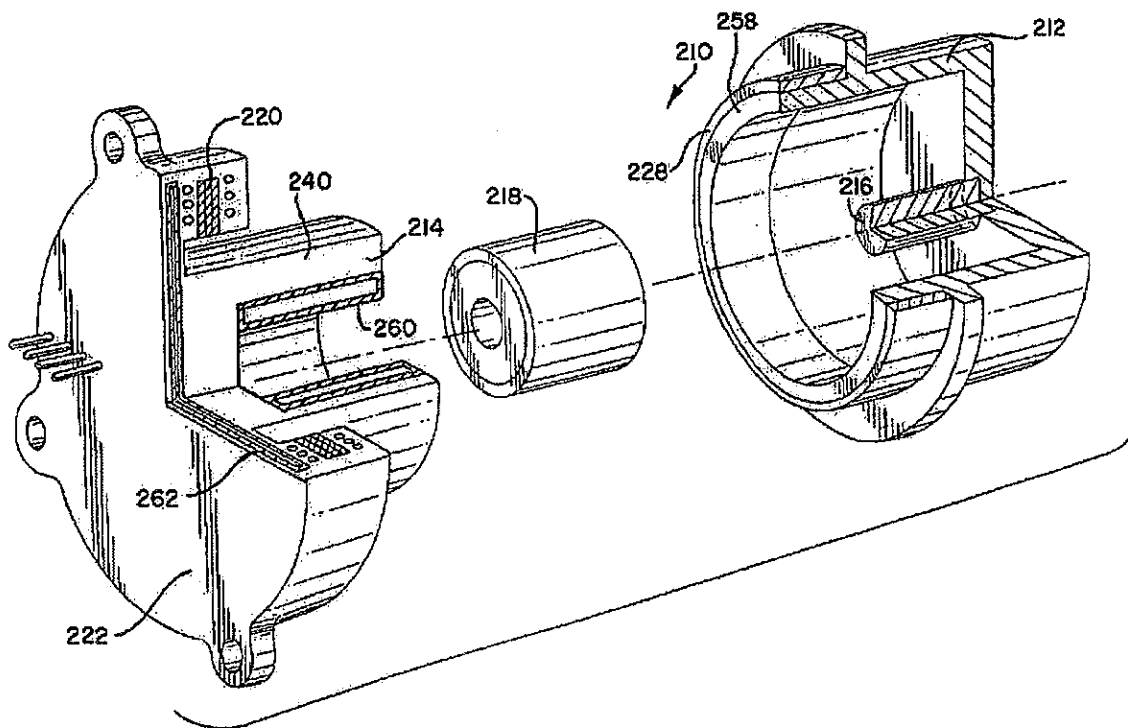

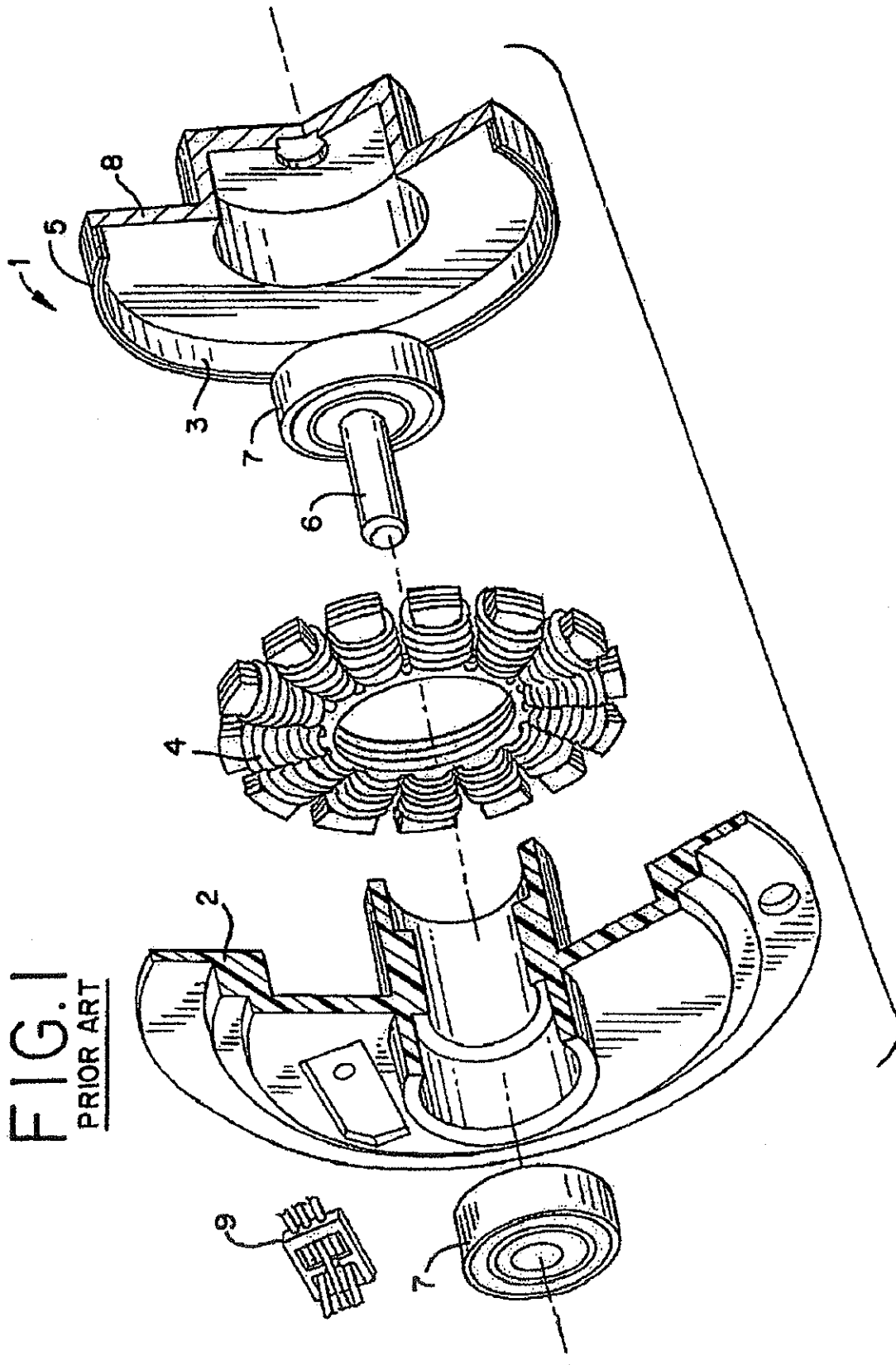

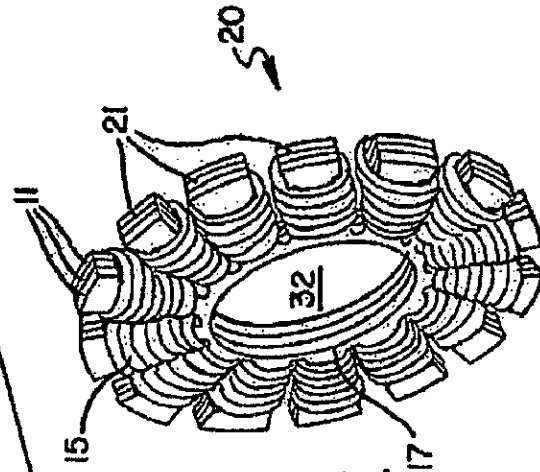
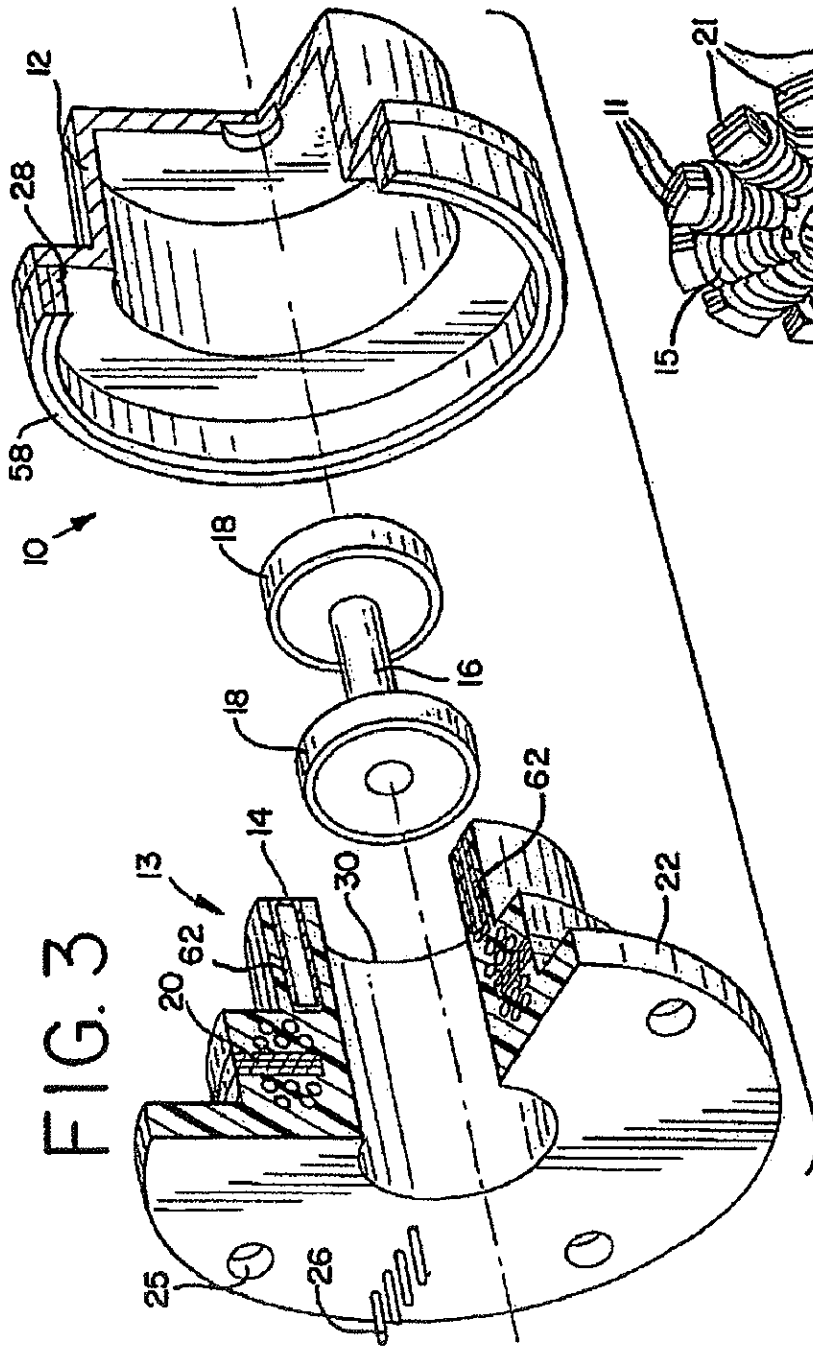

FIG. 2

FIG. 3

# Explore Litigation Insights

Docket Alarm provides insights to develop a more informed litigation strategy and the peace of mind of knowing you're on top of things.

## Real-Time Litigation Alerts



Keep your litigation team up-to-date with **real-time alerts** and advanced team management tools built for the enterprise, all while greatly reducing PACER spend.

Our comprehensive service means we can handle Federal, State, and Administrative courts across the country.

## Advanced Docket Research



With over 230 million records, Docket Alarm's cloud-native docket research platform finds what other services can't. Coverage includes Federal, State, plus PTAB, TTAB, ITC and NLRB decisions, all in one place.

Identify arguments that have been successful in the past with full text, pinpoint searching. Link to case law cited within any court document via Fastcase.

## Analytics At Your Fingertips



Learn what happened the last time a particular judge, opposing counsel or company faced cases similar to yours.

Advanced out-of-the-box PTAB and TTAB analytics are always at your fingertips.

## API

Docket Alarm offers a powerful API (application programming interface) to developers that want to integrate case filings into their apps.

## LAW FIRMS

Build custom dashboards for your attorneys and clients with live data direct from the court.

Automate many repetitive legal tasks like conflict checks, document management, and marketing.

## FINANCIAL INSTITUTIONS

Litigation and bankruptcy checks for companies and debtors.

## E-DISCOVERY AND LEGAL VENDORS

Sync your system to PACER to automate legal marketing.